



Let **UK** Home

1 Bedrooms

Flat

Located in London

£3,727 Per Month



info@letukhome.co.uk

<https://www.letukhome.co.uk/>

01795 358 886



86-92 Kensington Gardens Square London

W2 4BB



Let UK Home are excited to offer a one double bedroom apartment situated on the second floor of a private block located in London, W2.

The apartment comprises a spacious reception room, kitchen and windows overlooking "Kensington Garden Square", one double bedroom, and a bathroom. The apartment also benefits with access to the communal garden.

Overlooking tranquil Kensington Gardens Square, Garden House offers a rare collection of apartments. This Grade II listed building of distinction benefits from an exceptional outlook and direct access to these exclusive classic gardens.

Garden House is located in a quiet residential part of W2 and close to the amenities of Westbourne Grove, Notting Hill and the beautiful Hyde Park. It is also perfectly located for easy access to transport links with Bayswater and Queensway tube station just several minutes walk away.

86-92 Kensington Gardens Square London

£3,727 Per Month



- 1st Floor
- Access to a private gated communal garden
- Lift | Superfast Broadband
- Available furnished or unfurnished
- Porter
- One Double Bedroom Apartment
- Great transport links | Pet Friendly
- CCTV
- Laundry Service

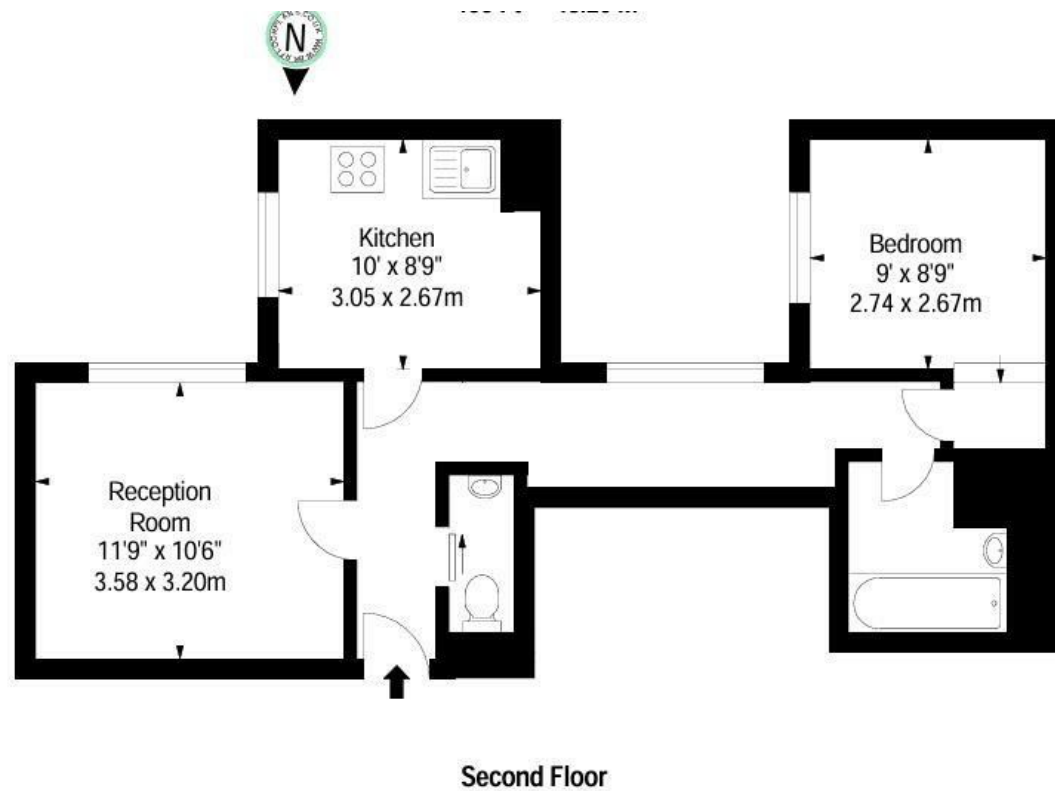

Let **UK** Home

3F 2 Eastbourne Terrace
Paddington
London
W2 6LG

01795 358 886

info@letukhome.co.uk

Council Tax Band:

Local Authority:

Agents Note: Whilst every care has been taken to prepare these particulars, they are for guidance purposes only. All measurements are approximate and are for general guidance purposes only and whilst every care has been taken to ensure their accuracy, they should not be relied upon and potential buyers/tenants are advised to recheck the measurements.

Energy Efficiency Rating		
	Current	Potential
Very energy efficient - lower running costs		
(92 plus) A		
(81-91) B		
(69-80) C		
(55-68) D		
(39-54) E		
(21-38) F		
(1-20) G		
Not energy efficient - higher running costs		
England & Wales		
EU Directive 2002/91/EC		

<https://www.letukhome.co.uk/>